

BAVONA

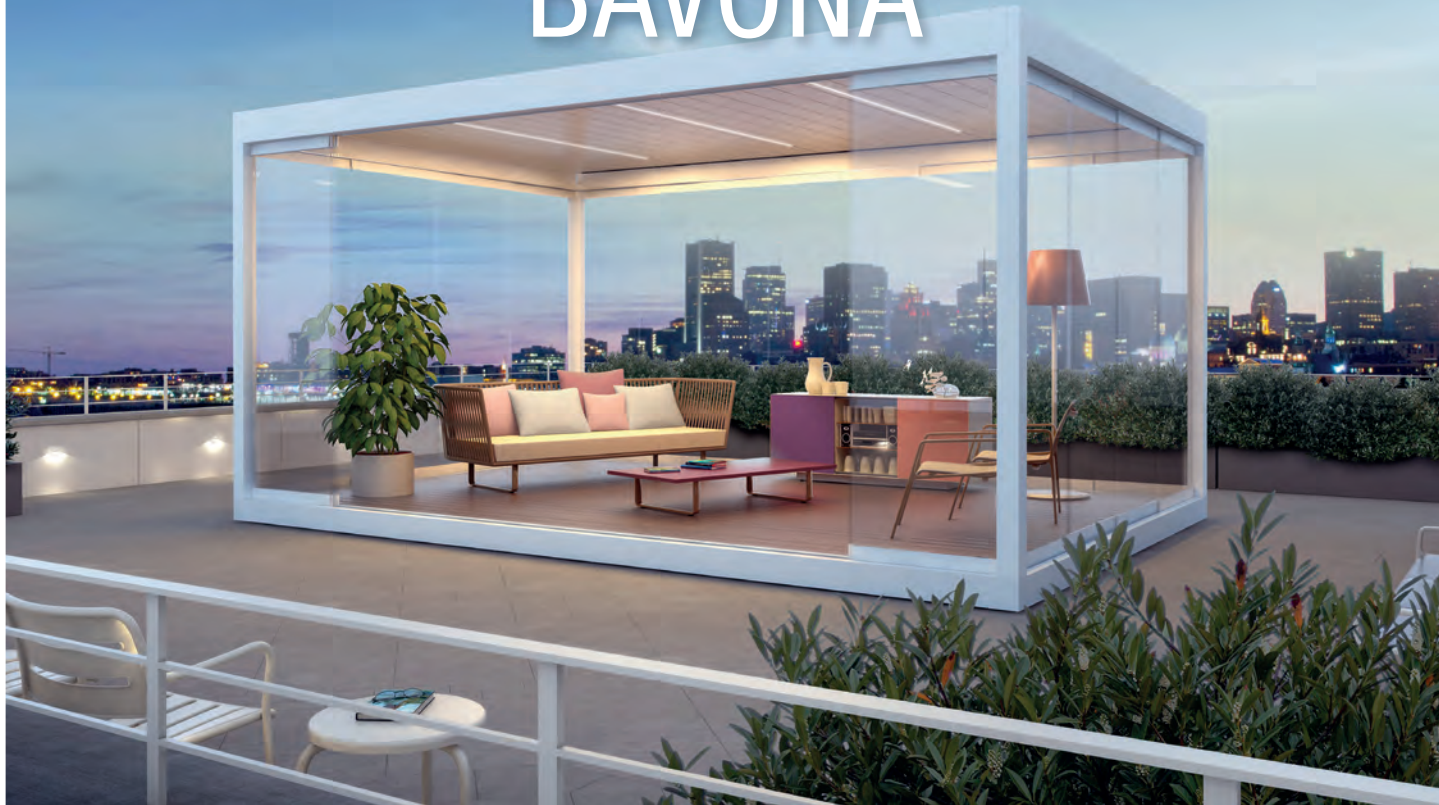

PERGOLA & PAVILLON

**MODULAR AND FLEXIBLE SYSTEM WITH
FABRIC OR LAMELLAS**



BAVONA TP6100 SOFTTOP | TP6500 HARDTOP

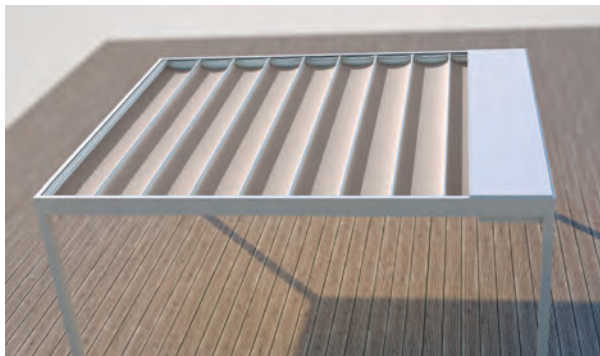

Roof variant Softtop



Patented scissor system



- Elegant solution for sun and rain protection
- Large dimensions up to 36 m² with only 4 supports
- Delicate corrosion-resistant aluminium construction in a cubic design
- Modular pergola system with two roof variants: Inclining aluminium lamellas to 115° (Hardtop), patented folding awning with watertight PVC fabric (Softtop)
- The patent ensures a narrow structure with high wind stability
- Diverse mounting possibilities: Free-standing, wall or corner mounting
- Standard motor drive
- Integrated water run-off through the supports
- Options: integrated, dimming LED illumination in the lamellas (TP6500); plug-in, dimming LED illumination on the water channel (direct/indirect); sliding side and front glazing; aluminium floor system SB4700 (I.S.L.A. Concept)

TP6100 Softtop



min. 200 cm
max. 500 cm



min. 200 cm
max. 600 cm



Post height
max. 277 cm



The wind resistance class can vary depending on version and dimension.



Technical dimensions in millimetres

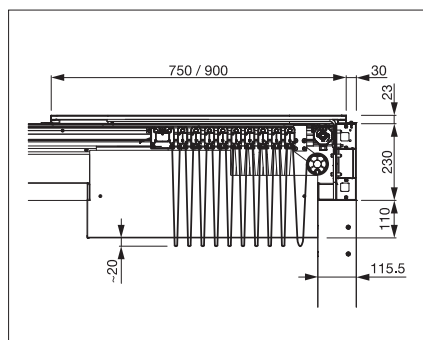

TP6100 Side view (fabric track detail)



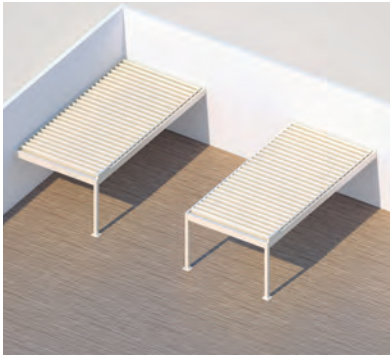

Roof variant Hardtop

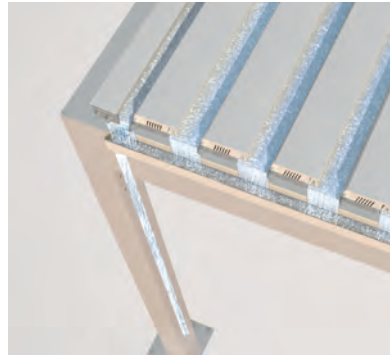

Guided drainage



LED lighting

TP6500 Hardtop



min. 200 cm
max. 600 cm*



min. 200 cm
max. 600 cm

*from 451 cm with 2 roof modules



Post height
max. 277 cm



The wind resistance class can vary depending on version and dimension.

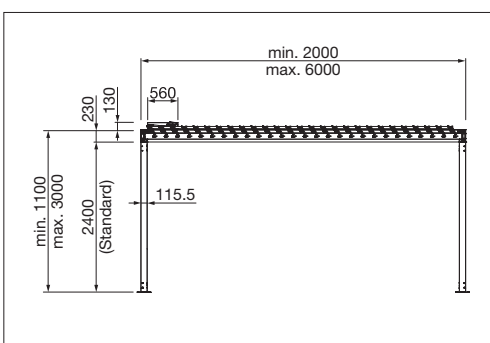

TP6500 Side view

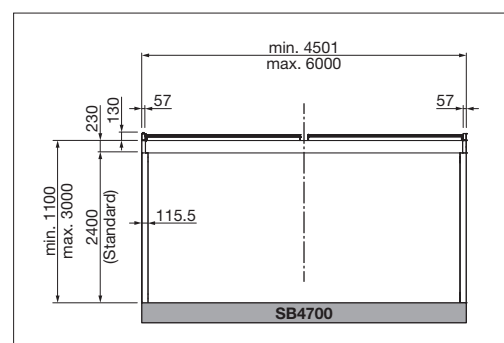

TP6500 Front view (2 roof module)



COLOURS

Discover the diverse options when selecting frame colours.



FABRICS

Choose from a comprehensive range of materials and colours.



ELECTRICS

More convenience thanks to the automated control and lighting systems.



**ENJOY THE TERRACE –
IN ANY WEATHER**